



EnerSol 245 - 270

— 0/+5 WP POSITIVE TOLERANCE

🏠 ROOFTOP AND OFF-GRID DESIGN

✓ HIGH QUALITY

25 year linear performance warranty
10 year product warranty

enerSol

High quality solar panels designed
for rooftop and off-grid applications



General characteristics

Cell	polycrystalline solar cell 156 x 156 mm
No. of Cells (Connections)	60 (6x10)
Panel Dimensions	1640 x 990 x 35 mm
Weight	18 – 19 kg
Connectors and cables	Connectors and 1.1m cables

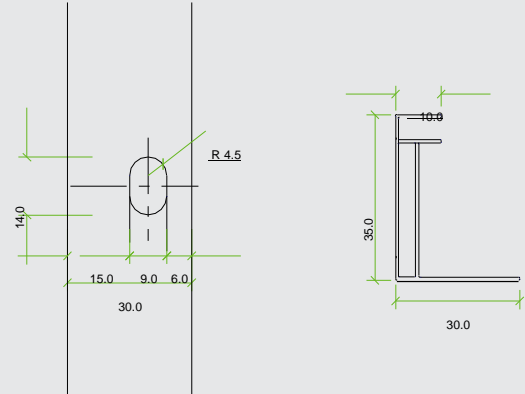
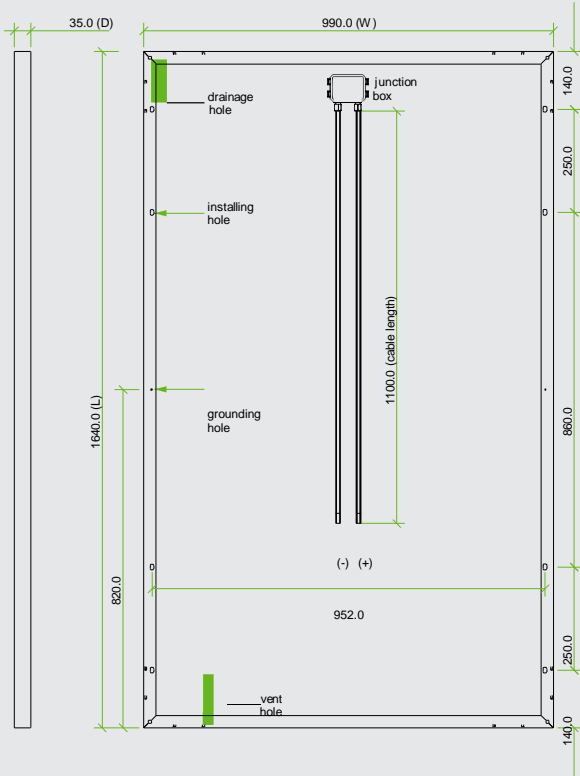

Thermal conditions

Normal Operating Cell Temperature 800W/m ² Irradiance, 20°C, AM = 1.5	48°C ± 2°C
Power Temperature Coefficient	- 0.5%/K
Current Temperature Coefficient	0.035%/K
Voltage Temperature Coefficient	- 0.37 MV/K

Limits

Operating Temperature	- 40°C to 85°C
Maximum System Voltage	1000V DC

Electric performance at STC *

	245 Wp	250 Wp	255 Wp	260 Wp	265 Wp	270 Wp
Power Tolerance	0/+5 Wp	0/+5 Wp	0/+5 Wp	0/+5 Wp	0/+5 Wp	0/+5 Wp
Module efficiency	15.20%	15.40%	15.70%	16.00%	16.30%	16.60%
Maximum Power Voltage	30.4V	30.8V	31.2V	31.2V	31.21V	31.21V
Maximum Power Current	8.05A	8.11A	8.17A	8.33A	8.49A	8.65A
Open Circuit Voltage	37.5V	38.1V	38.6V	38.6V	38.62V	38.62V
Short Circuit Current	8.67A	8.71A	8.77A	8.94A	9.05A	9.22A

*Standard Test Conditions: 1000W/m² irradiance, 25°C and AM = 1.5

High performance

25

25 Years
linear performance

10

10 Years
product warranty

